

# 190 Series

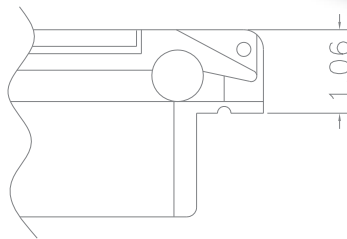

## 190 Series

Part No.	Hole Cut Out	O.D. of Deck Flange	O.D. of Lid	Spigot Length	Weight Lbs.	Cut Out Radius	Trim Ring	Extruded Screen
188	10" x 10" 254mm x 254mm	11 1/2" x 11 3/4" 280mm x 293mm	11 15/16" x 12" 303mm x 305mm	1 1/4"	10	3/4"	CT188	CS188
189	16 1/2" x 16 1/2" 420mm x 420mm	18 3/8" x 18 3/8" 453mm x 459mm	18 7/16" x 18 1/2" 468mm x 470mm	1 1/4"	18	1 1/8"	CT189	CS189
190	22 3/16" x 22 3/16" 564mm x 564mm	24 3/8" x 24 3/8" 625mm x 625mm	25 7/8" x 25 7/8" 657mm x 657mm	1 1/2"	27	2 3/8"	CT190	CS190
191	13 3/8" x 13 3/8" 333mm x 333mm	15" x 15" 381mm x 381mm	15 3/8" x 15 3/8" 390mm x 390mm	1 1/4"	14	1 1/8"	CT191	CS191
192	24" x 28" 610mm x 710mm	27" x 30 1/4" 685mm x 780mm	28" x 32" 711mm x 813mm	1 1/2"	30	2 3/4"	N/A	N/A
193	20" x 20" 510mm x 510mm	22 1/2" x 22 1/2" 572mm x 572mm	23" x 23" 584mm x 584mm	1 1/2"	25	2 3/4"	CT193	NS193

NOTE: 192 is hinged on 24" side and is available in black, white, or silver powder coat only. When ordering trim ring specify black or off-white. Black is standard .

## CAST HATCH features

- « Polished & anodized (except 192).
- « Traditional low profile.
- « Cast aluminum Almag-35.
- « Acrylic lens.
- « Quick action dogs.
- « Overall Height is approximately 1".
- « CE approval available. Please specify when ordering.



**BOMAR**  
**BOWVB**